

1M150C series

Your ultimate power solution **150 Watts**



FEATURES

- High efficiency
- High reliability
- Protections: Over-voltage/Over-current/Over-power/Short-circuit
- Output reverse protection
- VAC input range selected by switch
- 100% full load burn-in test
- EMI/RFI: FCC Part 15J, Class A & CISPR 22 Class A
- DC adjust range
- Free air cooling convection
- LED Power on indication
- Warranty: 3 years
- 199* 110* 50 mm
- Weight: 0.73kgs/pc

MODEL LISTING

MODEL	OUTPUT
FS-15012-1M	12V/12.5A
FS-15024-1M	24V/6.5A

Consult factory for alternate output configurations

All Specifications are maximum at 25°C unless otherwise stated and are subject to change without notice.

OUTPUT SPECIFICATIONS

1. Connector : 7P / 9.5mm pitch terminal block
2. DC adjust range : +/-10% of rated output voltage
3. Set up time<1000 ms, Rise time <50 ms, Hold up Time>20 ms : at 230Vac/50Hz
4. Over Voltage Protection : 115%~135% of rated output
5. Over Power Protection : 110% ~ 200%, auto-recovery
6. Short Circuit Protection : Hiccup mode
7. Overshoot and Undershoot : autorecovery
8. Ripple And Noise

Oscilloscope	Output Voltage	Maximum Ripple & Noise(Vp-p)
20 MHz	12V	120mV
20 MHz	24V	240mV

INPUT SPECIFICATIONS

1. Input range : 90~132Vac/ 180~264Vac selected by switch
2. Frequency : 47-63Hz
3. AC inrush current : Cold start, 40A @ 230Vac, 50Hz, 25C degree
4. Efficiency

12V	>84% @ 115 Vac/60 Hz
24V	>85% @ 115 Vac/60 Hz

5. Isolation resistance : I/P-O/P, I/P-FG, O/P-FG:100M ohms/500VDC
6. Input Current Protection : A fuse with rated of 4A/250V

ENVIRONMENTAL

1. Operating temperature: -10°C to +50°C (refer to derating curve)
2. Operating humidity: 10% to 90% RH, non-condensation
3. Storage temperature: -20°C to +80°C
4. Storage humidity: 5% to 95% RH, including condensation
5. Vibration operation: 10 to 250Hz, 0.25G p-p, 3 axes, 15 min sweep

ELECTROMAGNETIC COMPATIBILITY

Electrostatic Discharge: (ESD) EN61000-4-2 +/-4kV Contact discharge
+/-8kV Air discharge

Fast Transient Immunity,(EFT) EN61000-4-4 +/-2kV

Surge Immunity EN61000-4-5 +/-1kV(L-L)
+/-2kV(L-PE)

APPLICATION INFORMATION

Factory Automation

1. Process Control
2. NC-Machining/Automotive
3. Packaging Equipment
4. Materials Handling
5. Chemical Processing/Robots
6. Computer equipment

Led application

1. LED Digital Display
2. LED Video Display
3. LED Lighting

And Other Application ...

Test & Measurement

1. Burn-in Test
2. Automated Test
3. Instrumentation
4. Detection Measurement

MAXIMUM OUTPUT POWER VS.

AMBIENT TEMPERATURE

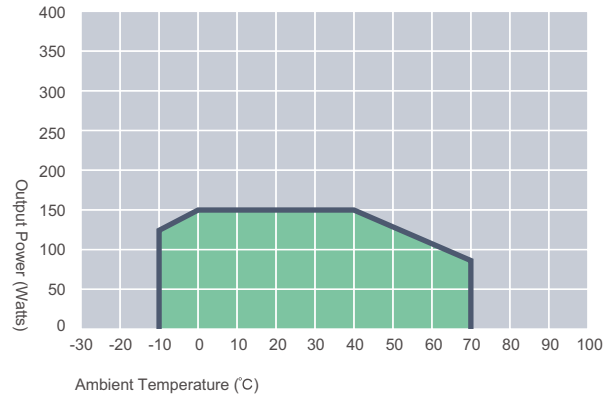

1M150W SERIES MECHANICAL SPECIFICATIONS

CHASSIS & COVER

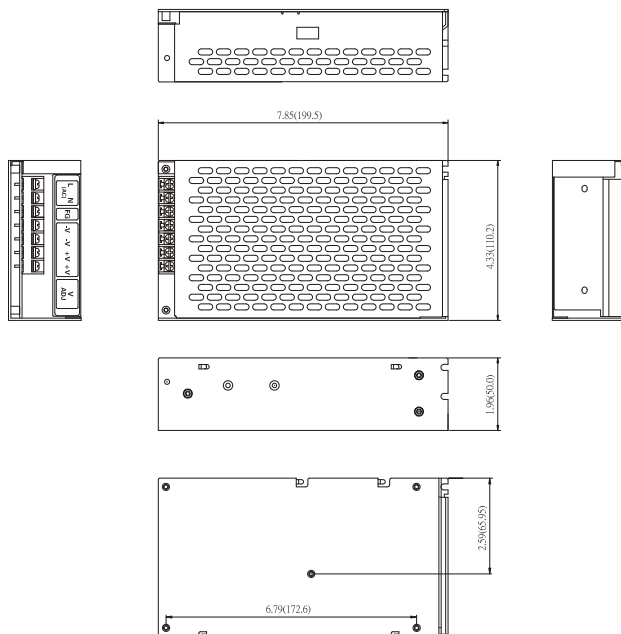

OPEN FRAME

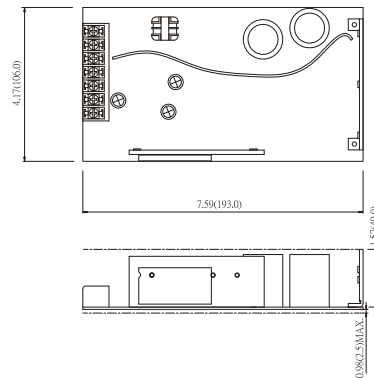

ALL DIM : INCHES (mm)